

- 10. FOR SPECIFIC INFORMATION CONTACT SALES.
- 9. COMPLETE ASSEMBLY WEIGHT W/ DECK RING, 29LBS/ 13.2K.
- 8. DOGGING PRESSURE FULLY ADJUSTABLE.
- 7. HANDLE POSITION TOPSIDE INDICATES WHETHER DOGGING MECHANISM IS IN OPEN OR CLOSED POSITION.
- 6. ALUMINUM MECHANISM SHOWN.
- 5. FLUSH, WATERTIGHT CONSTRUCTION.
- 4. INTEGRAL TOPSIDE "T" HANDLE STANDARD, OTHER TOPSIDE ACTUATION AVAILABLE.
- 3. MS COAMING CAN BE WELDED.
- 2. QUICK-ACTING, MECHANISM ENGAGES OR DISENGAGES IN QUARTER-TURN OF CENTER SPINDLE.
- 1. 15.1" / 383MM DIAMETER CLEAR OPENING, ALL DIMENSIONS SHOWN SUBJECT TO CASTING VARIATION AND ARE REFERENCE ONLY.

NOTES: UNLESS OTHERWISE SPECIFIED.

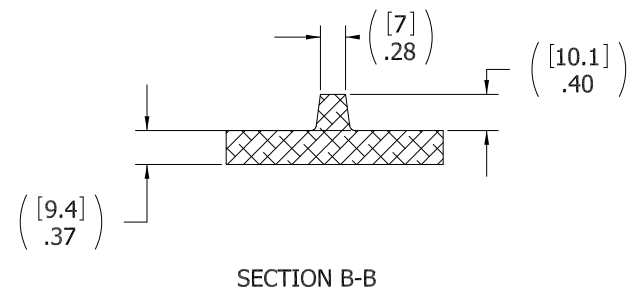

A

CUSTOMER APPROVAL

Signature: _____

Date: _____

IMPORTANT! THIS DRAWING SUPERSEDES ALL OTHER DOCUMENTS. By signing this approval you accept and agree that the dimensions and details shown are correct and properly fit your application, regardless of any differences between this drawing and any contract specifications. Should you see any errors in the drawing, or have any questions, please contact your Freeman Marine sales engineer for clarification.

SPECIFICATIONS SUBJECT TO CHANGE WITHOUT NOTICE.			
PROJECTION			
UNLESS OTHERWISE SPECIFIED DIMENSIONS ARE IN INCHES. TOLERANCES FOR ROUGH AND CLEAR OPENINGS: .125 INCH. ALL OTHERS ARE:			
.X	.XX	.XXX	ANGLES
±.1	±.03	±.010	±2°
DO NOT SCALE DRAWING			
REV.	DESCRIPTION:	DATE:	DRAWN
-	INITIAL RELEASE	26AUG05	MRS
A	UPDATE GEN NOTES & B.O.M.	05JUL11	GJM

		28336 HUNTER CREEK ROAD GOLD BEACH, OR 97444 U.S.A. PHONE: 541-247-7078 FAX: 541-247-2114 www.freemanmarine.com	
		CLIENT:	FREEMAN MARINE
DRAWN: M STENDER DATE: 26AUG05 CHECKED: P CANCELLIERI DATE: 05JUL11 ENGR: DATE: DESIGN ACTIVITY: DATE: CONTRACT NO.:		TITLE:	15" ROUND CAST HATCH ALUMINUM DECK RING
SIZE:	D	CAGE CODE:	64747
DRAWING NUMBER:	2403-0003	REV.:	A
SCALE:	1:2	CALC. WT.:	ACT. WT.:
			SHEET 1 OF 3

8 7 6 5 4 3 2 1

D

C

B

A

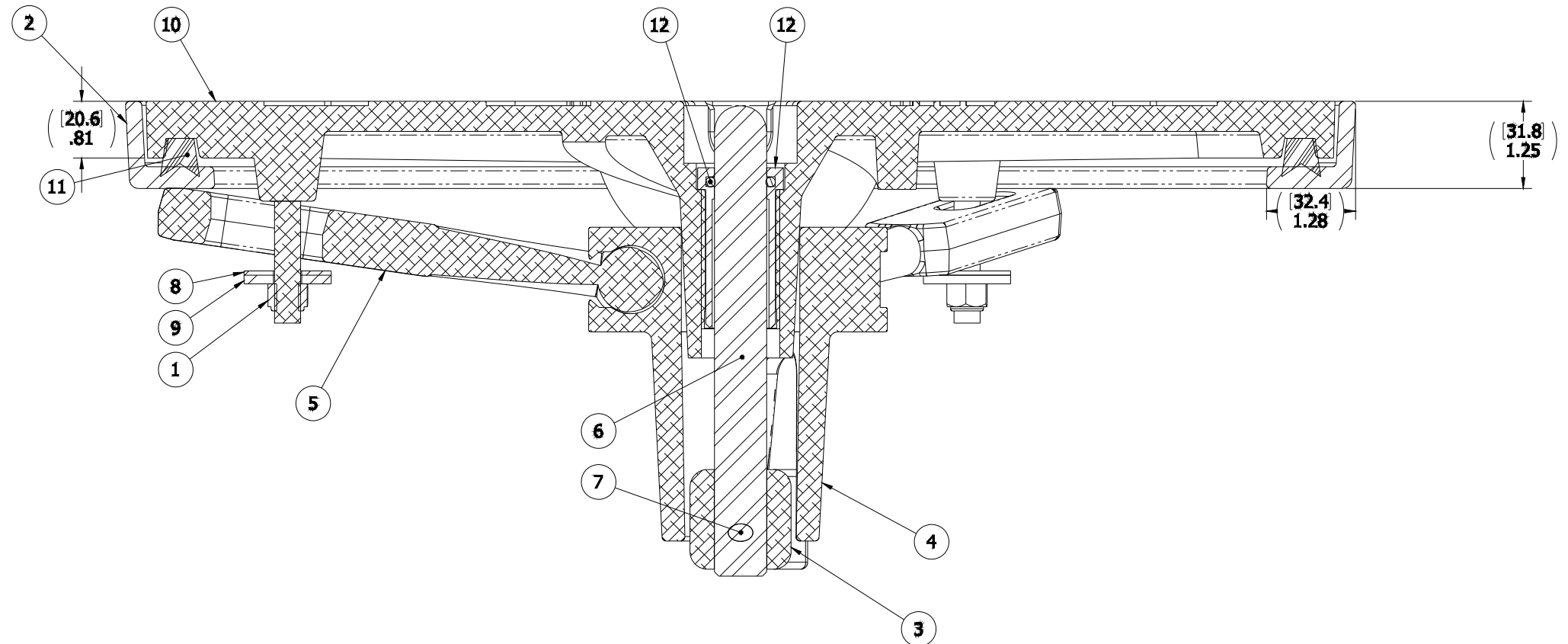

SECTION A-A

ITEM NO.	QTY.	PART NUMBER	DESCRIPTION	MATERIAL
12	1	0031-2058	BUSHING ASSY, W/O-RING, NO SLEEVE	ACETRON/RUBBER
11	1	9801-2004	GASKET	50 DURO NEOPRENE, 0631-9801
10	1	2403-3003	COVER: 15 ROUND	ALUMINUM, A356.0-F
9	3	0411-2033	WASHER, .406 X 1.25 X .125IN SS 316	SS 316/316L
8	3	0413-2005	WASHER, .406 X 1.250 X .062 NYLON	NYLON
7	1	0411-2004	PIN KNURLED .25 X 2.25IN SS 316	SS 316/316L
6	1	0021-2005	HANDLE, S/S, ROUND BAR	STAINLESS STEEL, 316
5	3	0211-2004	DOG, LOCKING ARM	ALUMINUM, 535.2-F
4	1	0011-2001	HUB, 3 HOLE	ALUMINUM, 535.2-F
3	1	0112-2001	ACTUATOR, AL	ALUMINUM, 535
2	1	2403-1005	RING: 15"	STEEL, A36
1	3	0411-2032	NUT .375IN-16 SS 316 NYLOCK	SS 316/316L

SPECIFICATIONS SUBJECT TO CHANGE WITHOUT NOTICE.		FREEMAN MARINE EQUIPMENT, INC.		28336 HUNTER CREEK ROAD GOLD BEACH, OR 97444 U.S.A. PHONE: 541-247-7078 FAX: 541-247-2114 www.freemanmarine.com	
PROJECTION		UNLESS OTHERWISE SPECIFIED DIMENSIONS ARE IN INCHES. TOLERANCES FOR ROUGH AND CLEAR OPENINGS: .125 INCH. ALL OTHERS ARE:		CLIENT: FREEMAN MARINE	
.X .XX .XXX ANGLES ±.1 ±.03 ±.010 ±2°		DO NOT SCALE DRAWING		TITLE: 15" ROUND CAST HATCH ALUMINUM DECK RING	
- INITIAL RELEASE 26AUG05 MRS		DATE: 26AUG05		DRAWN: M STENDER	
A UPDATE GEN NOTES & B.O.M. 05JUL11 GJM		CHECKED: P CANCELLIERI 05AUG11		ENGR:	
REV. DESCRIPTION: DATE: DRAWN		DESIGN ACTIVITY: DATE:		CONTRACT NO.:	
		SIZE: D		CAGE CODE: 64747	
		DRAWING NUMBER: 2403-0003		REV. A	
		SCALE: 1:1		SHEET 2 OF 3	

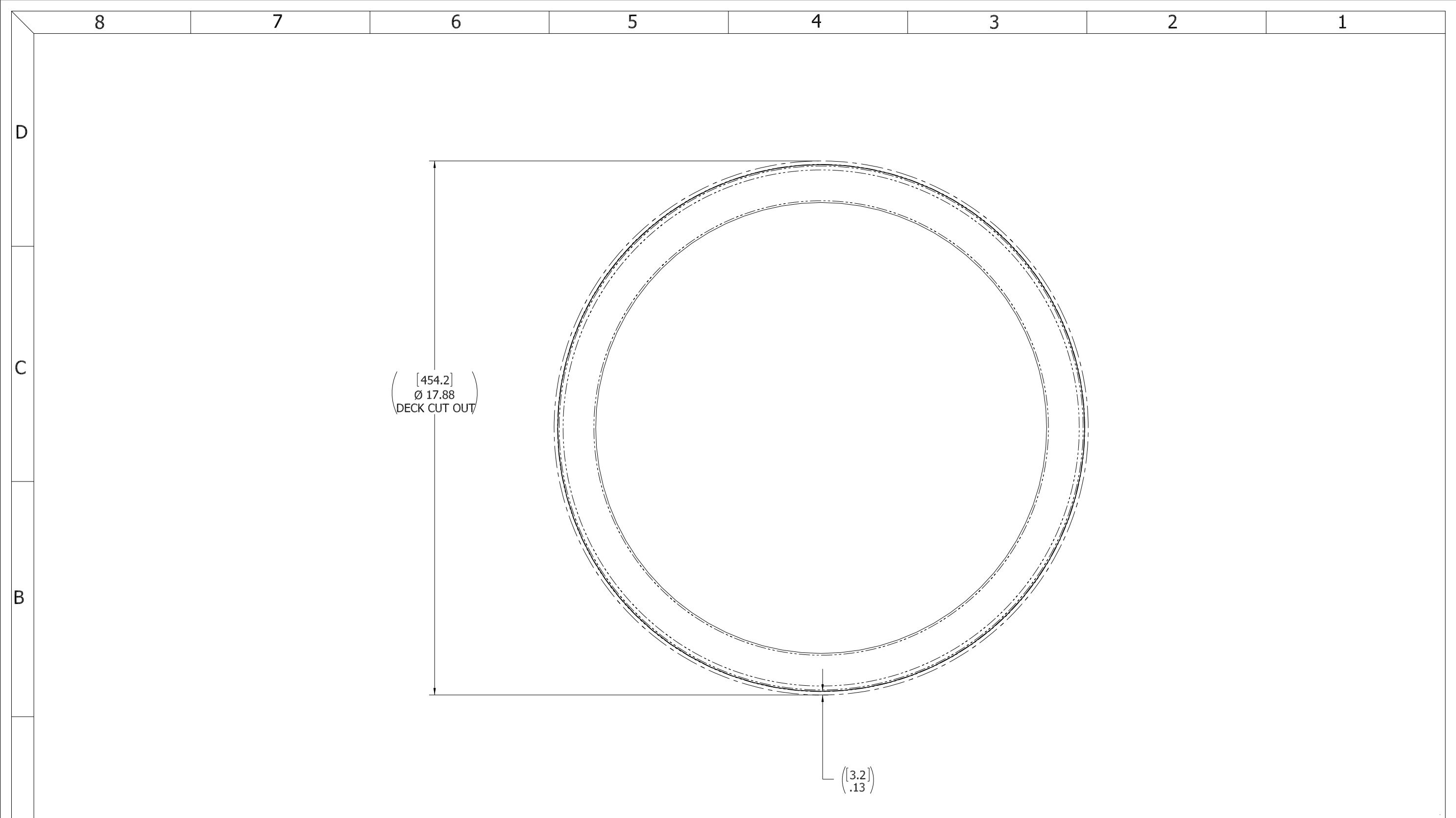

- 3. FINISH: 125 RMS MAX.
- 2. BREAK SHARP EDGES AND DEBURR.
- 1. MATERIAL: REF. S/A - B.O.M.

NOTES: UNLESS OTHERWISE SPECIFIED.

CUSTOMER APPROVAL

Signature: _____
 Date: _____

IMPORTANT! THIS DRAWING SUPERSEDES ALL OTHER DOCUMENTS. By signing this approval you accept and agree that the dimensions and details shown are correct and properly fit your application, regardless of any differences between this drawing and any contract specifications. Should you see any errors in the drawing, or have any questions, please contact your Freeman Marine sales engineer for clarification.

REV.	DESCRIPTION	DATE	DRAWN
-	INITIAL RELEASE	26AUG05	MRS
A	UPDATE GEN NOTES & B.O.M.	05JUL11	GJM

SPECIFICATIONS SUBJECT TO CHANGE WITHOUT NOTICE.

PROJECTION

UNLESS OTHERWISE SPECIFIED DIMENSIONS ARE IN INCHES. TOLERANCES FOR ROUGH AND CLEAR OPENINGS: .125 INCH. ALL OTHERS ARE:
 .X .XX .XXX ANGLES
 ±.1 ±.03 ±.010 ±2°

DO NOT SCALE DRAWING

 <small>CONFIDENTIAL PROPERTY OF FREEMAN MARINE EQUIPMENT, INC. UNLESS OTHERWISE SPECIFIED. ALL RIGHTS RESERVED. THIS DRAWING IS THE PROPERTY OF FREEMAN MARINE EQUIPMENT, INC. AND SHALL BE RETURNED UPON REQUEST.</small>		28336 HUNTER CREEK ROAD GOLD BEACH, OR 97444 U.S.A. PHONE: 541-247-7078 FAX: 541-247-2114 www.freemanmarine.com	
		CLIENT:	FREEMAN MARINE
DRAWN: M STENDER		DATE: 26AUG05	TITLE: 15" ROUND CAST HATCH ALUMINUM DECK RING
CHECKED: P CANCELLIERI		DATE: 05JUL11	
ENGR:		DATE:	SIZE: D
DESIGN ACTIVITY:		DATE:	CAGE CODE: 64747
CONTRACT NO.:		SCALE: 2:3	DRAWING NUMBER: 2403-0003
		CALC. WT.	ACT. WT.
		SHEET 3 OF 3	