

PLAN

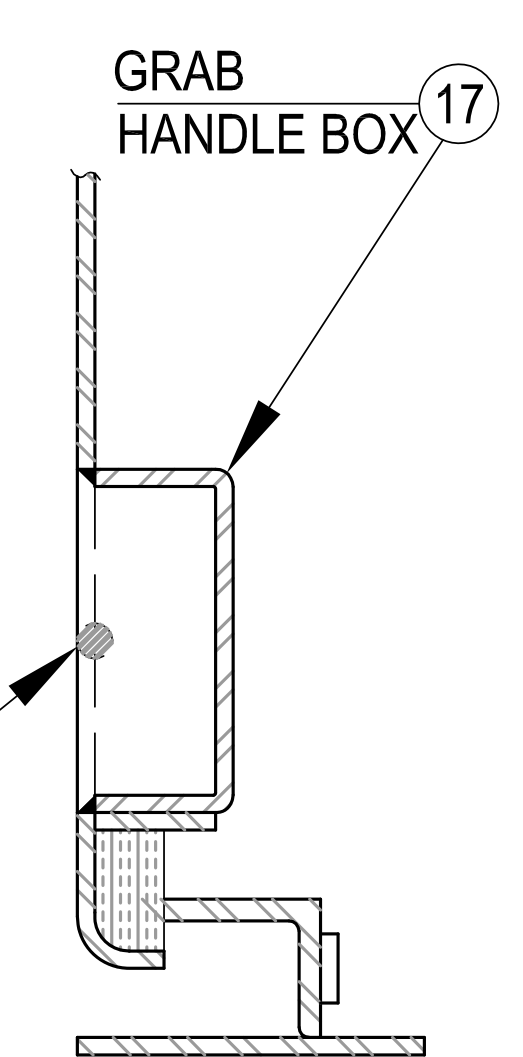

SECTION 'X-X'

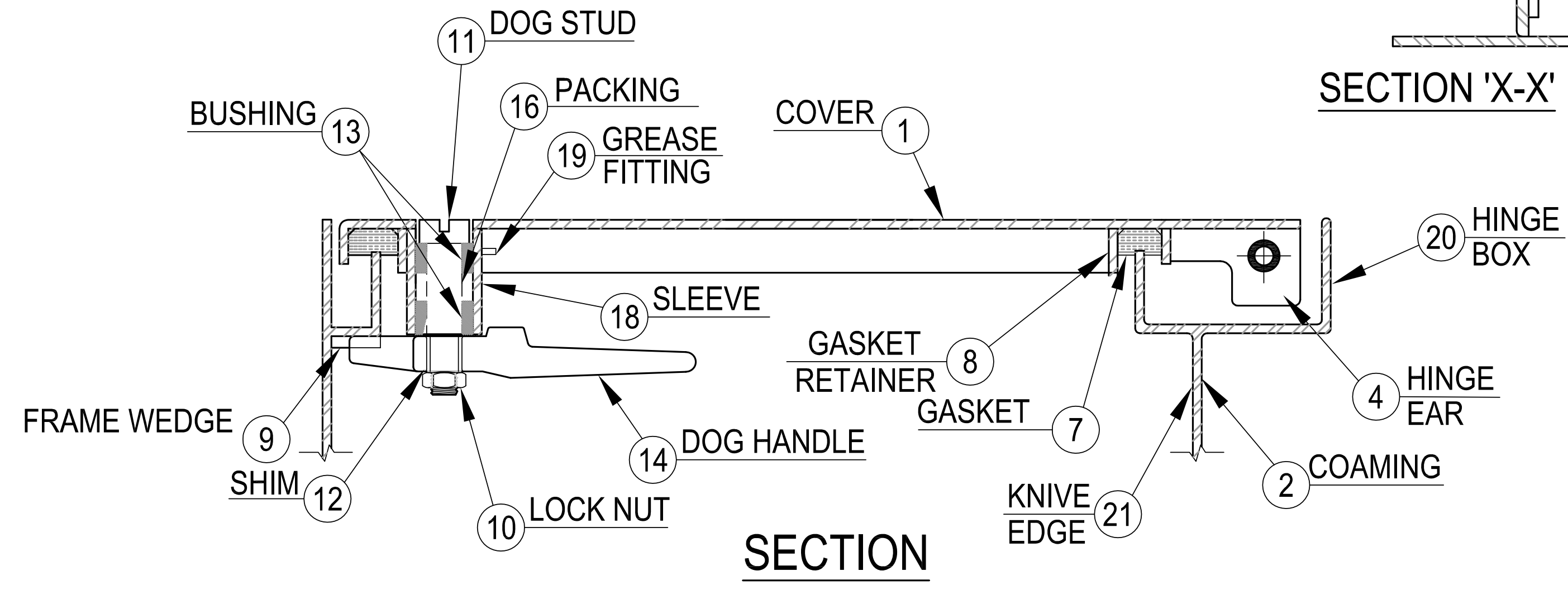

SECTION

SCHEDULE OF MATERIALS

PC.	MATERIAL	REMARKS
1	MILD STEEL	
2	MILD STEEL	
3	MILD STEEL	
4	MILD STEEL	
5	MILD STEEL	
6	STAINLESS	
7	NEOPRENE	
8	MILD STEEL	
9	FORGED STEEL	
10	PLATED STEEL	
11	BRASS	
12	STAINLESS	
13	DELTRIN	
14	MANGANESE BRONZE	
15	MILD STEEL	
16	TEFLON	
17	MILD STEEL	
18	MILD STEEL	
19	PLATED	
20	MILD STEEL	
21	MILD STEEL	
22	COLD FINISH	

D
C
B
A

NOTES: UNLESS OTHERWISE SPECIFIED.

CUSTOMER APPROVAL
Signature: _____
Date: _____
IMPORTANT! THIS DRAWING SUPERSEDES ALL OTHER DOCUMENTS. By signing this approval you accept and agree that the dimensions and details shown are correct and properly fit your application, regardless of any differences between this drawing and any contract specifications. Should you see any errors in the drawing, or have any questions, please contact your Freeman Marine sales engineer for clarification.

SPECIFICATIONS SUBJECT TO CHANGE WITHOUT NOTICE.		FREEMAN MARINE EQUIPMENT, INC.		28336 HUNTER CREEK ROAD GOLD BEACH, OR 97444 U.S.A. PHONE: 541-247-7078 FAX: 541-247-2114 www.freemanmarine.com	
UNLESS OTHERWISE SPECIFIED DIMENSIONS ARE IN INCHES, TOLERANCES FOR ROUGH AND CLEAR OPENING ± .125 INCH. ALL OTHERS ARE: .X .XX .XXX ANGLES ±.1 ±.03 ±.010 ±2°		CONFIDENTIAL PROPERTY OF FREEMAN MARINE EQUIPMENT, INC. UNAUTHORIZED USE, REPRODUCTION OR DISTRIBUTION IS STRICTLY PROHIBITED. ALL COPIES REMAIN THE PROPERTY OF FREEMAN MARINE EQUIPMENT, INC. AND MUST BE RETURNED UPON REQUEST.		CLIENT: FREEMAN MARINE	
PROJECTION		DRAWN: ZC DATE: 2/27/20 CHECKED: DATE: ENGR: DATE: DESIGN ACTIVITY: DATE: CONTRACT NO.:		TITLE: WATERTIGHT OVAL HATCH SIZE: D CAGE CODE: 64747 DRAWING NUMBER: 212-MS REV. 00	
DO NOT SCALE DRAWING		SCALE: 1:5.5 CALC. WT. ACT. WT.		SHEET 1 OF 1	